

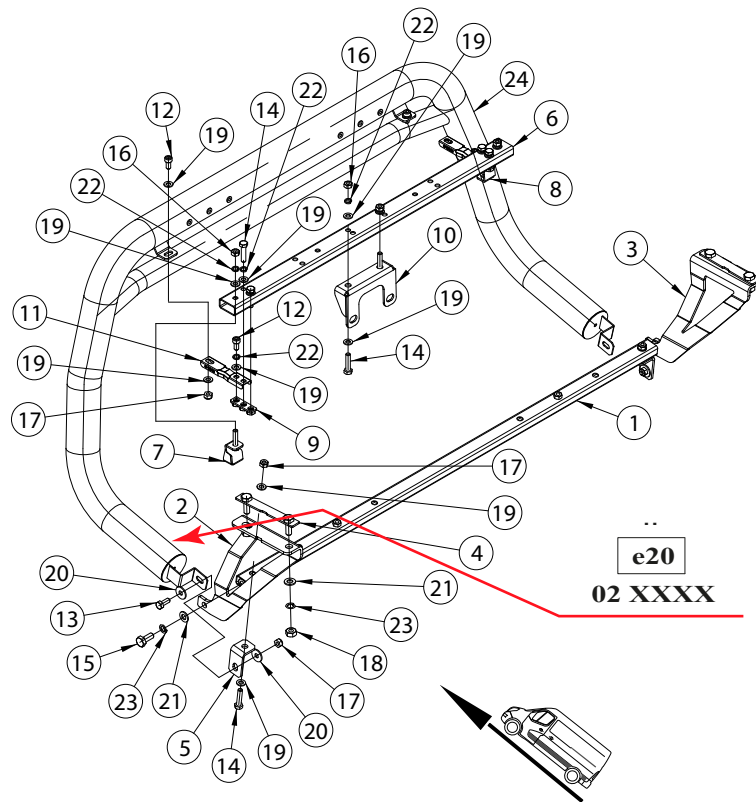

Renault Master 2019-

Art. 82840570, 82840571

Eurobar | Eurobar | Евробар | Eurobar

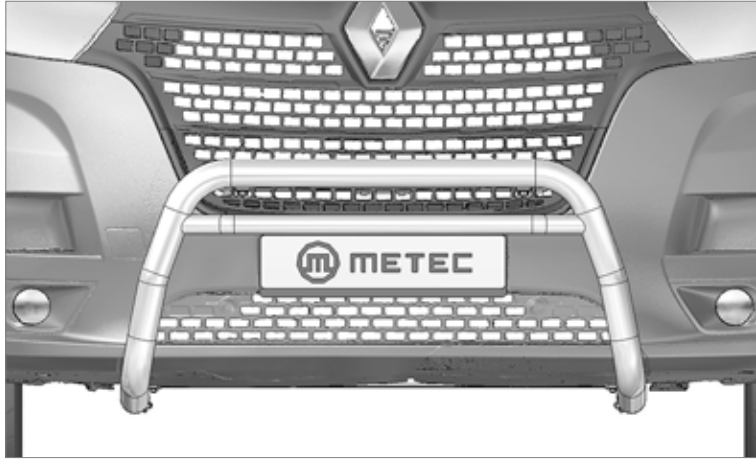

- | | |
|---|----|
| 1. Tala / support / переклад / Unterstützung | 1 |
| 2. Kronstein / bracket / кронштейн / Konsole (LH) | 1 |
| 3. Kronstein / bracket / кронштейн / Konsole (RH) | 1 |
| 4. U-polt / U-bolt / U-болт / U-bolzen | 2 |
| 5. Vinkel / angeled plate / угольник / winkel | 2 |
| 6. Tala / support / переклад / Unterstützung 40x20 | 1 |
| 7. Kronstein / bracket / кронштейн / Konsole (LH) | 1 |
| 8. Kronstein / bracket / кронштейн / Konsole (RH) | 1 |
| 9. Plaat / plate / пластина / Platte | 2 |
| 10. Kronstein / bracket / кронштейн / Konsole | 1 |
| 11. Kompensator / compensator / компенсатор / Kompensator | 2 |
| 12. Polt / bolt / болт / Bolzen M8x16 | 4 |
| 13. Polt / bolt / болт / Bolzen M8x20 | 2 |
| 14. Polt / bolt / болт / Bolzen M8x35 | 8 |
| 15. Polt / bolt / болт / Bolzen M10x25 | 2 |
| 16. Mutter / nut / гайка / Mutter M8 DIN934-A2 | 4 |
| 17. Mutter / nut / гайка / Mutter M8 DIN985-A2 | 6 |
| 18. Mutter / nut / гайка / Mutter M10 | 4 |
| 19. Seib / flat washer / шайба / Scheibe 8,4x16x1,6 | 20 |
| 20. Seib / flat washer / шайба / Scheibe 8,4x24x2 | 4 |
| 21. Seib / flat washer / шайба / Scheibe 10,5x20x2 | 6 |
| 22. Vedruseib / spring washer / пружинная шайба / Federnscheibe A8 | 10 |
| 22. Vedruseib / spring washer / пружинная шайба / Federnscheibe A10 | 6 |
| 24. Eurobar / eurobar / евробар / eurobar | 1 |

e20
02 XXXX

M8 - 25 Nm
M10 - 50 Nm

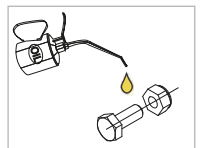

Kaal / Weight / Масса / Gewicht: 10 kg

Paigaldusaeg ilma elektritöödetä / Time of mounting w/o wiring works / Время установки без электромонт. работ / Einbauzeit ohne elektrische arbeit: 60 min

Maksim. lubatud laternapaigaldise kaal / Max. weight of assembly of extralights / maximale zulässige Gewicht der Zusatzscheinwerfer: 3 kg

Vajalikud tööriistad / Required Tools / Необходимые инструменты / Benötigte Werkzeuge



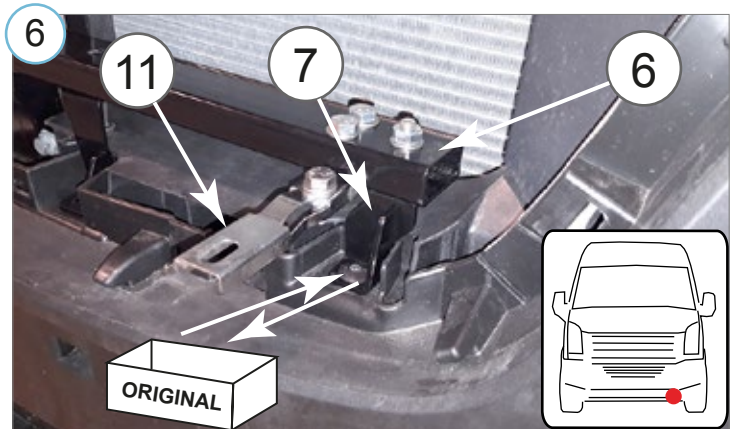
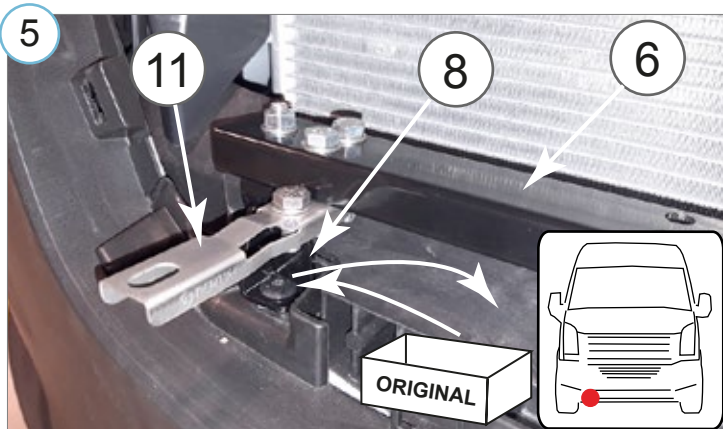
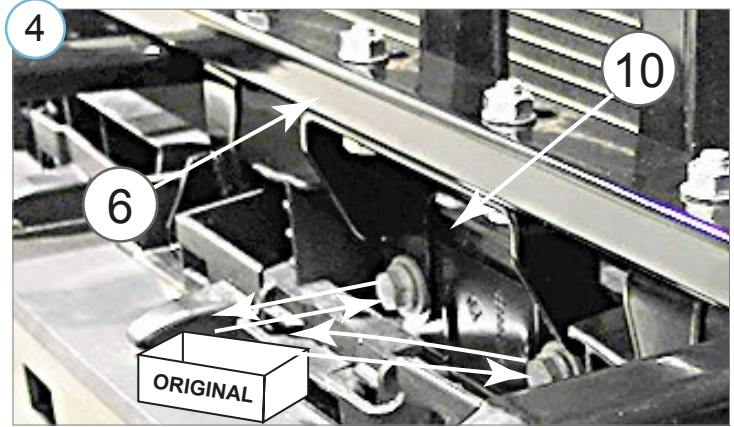
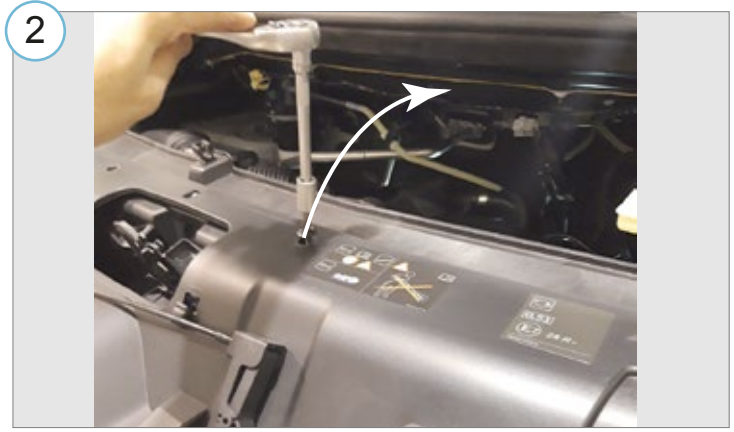
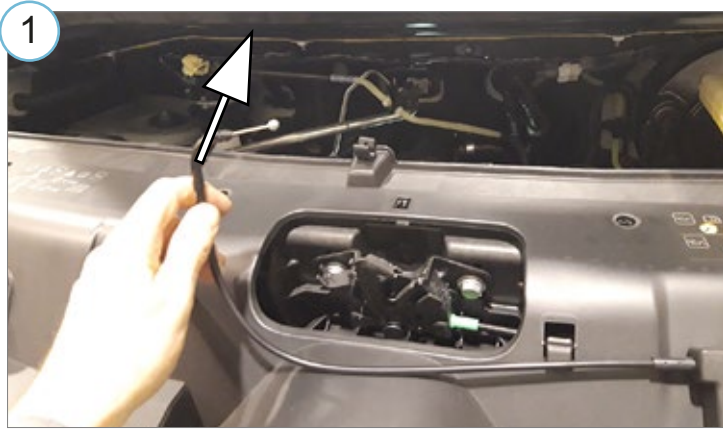

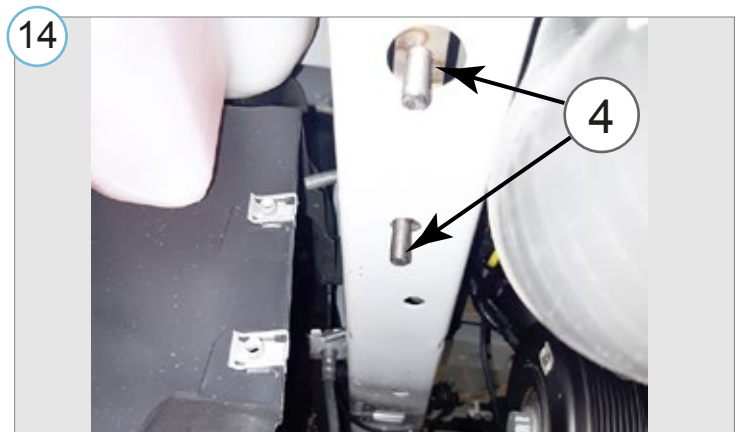
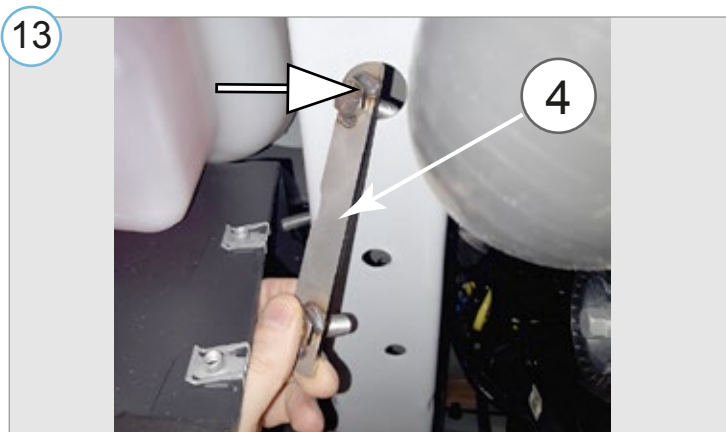
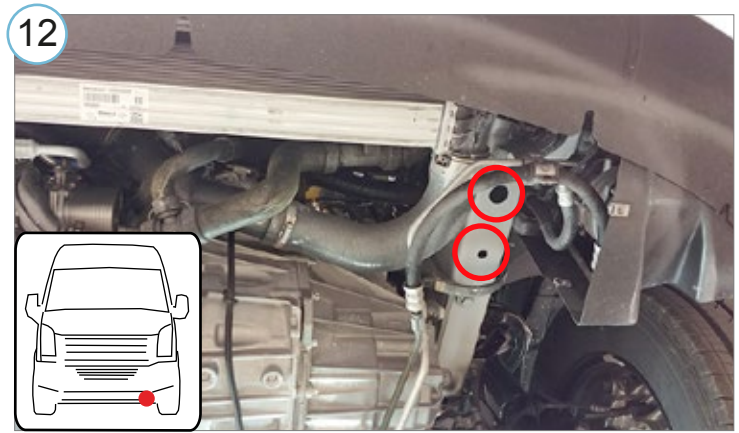
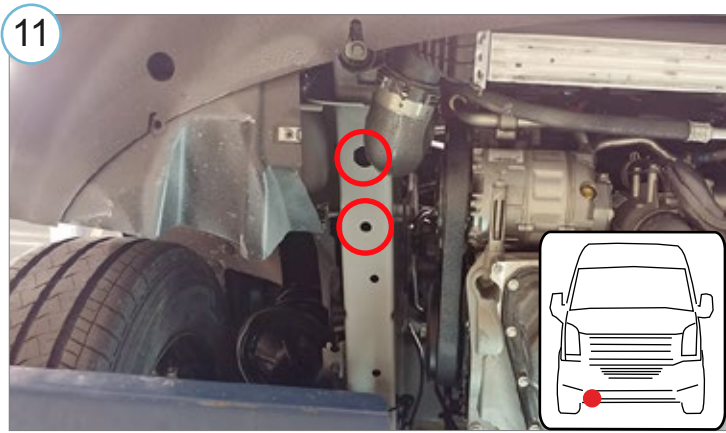
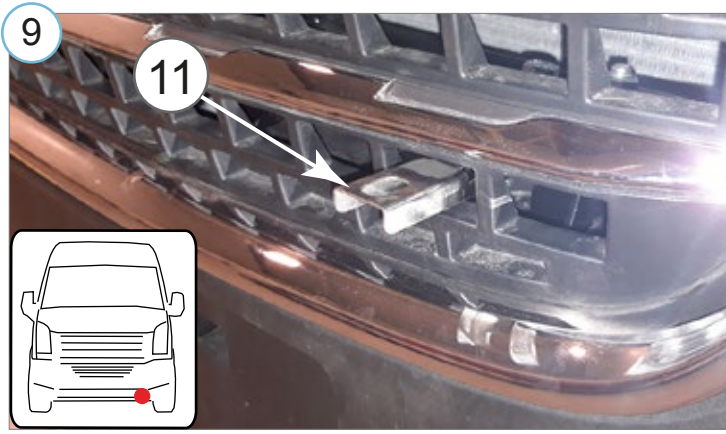

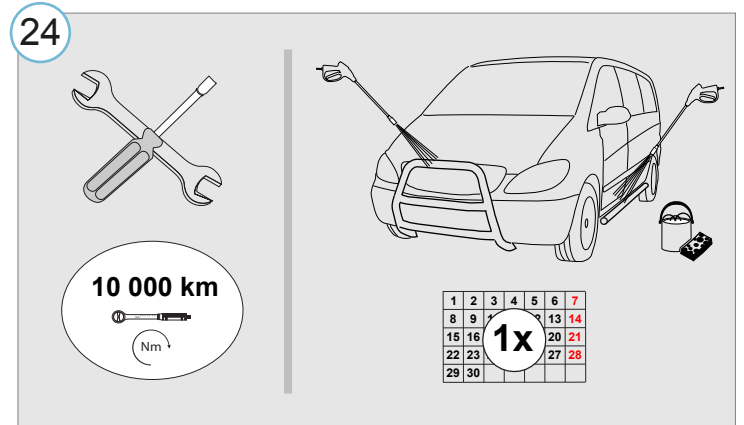
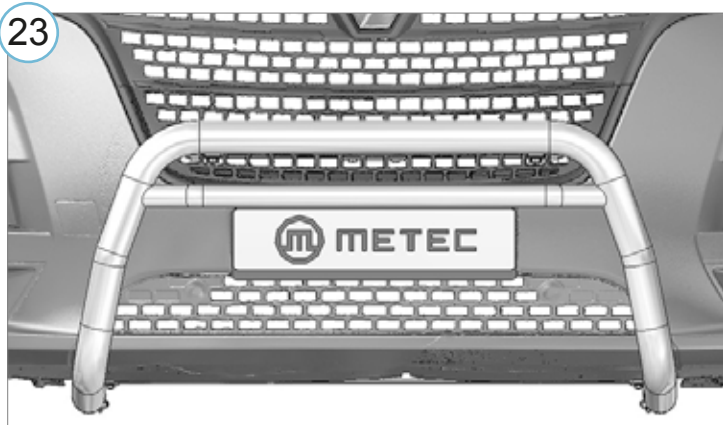
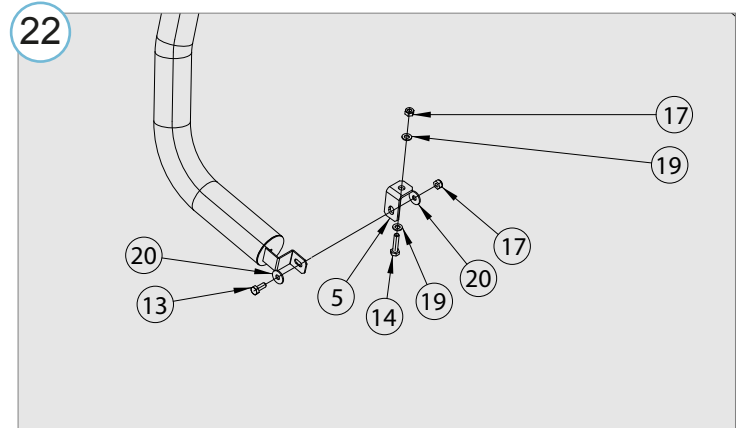
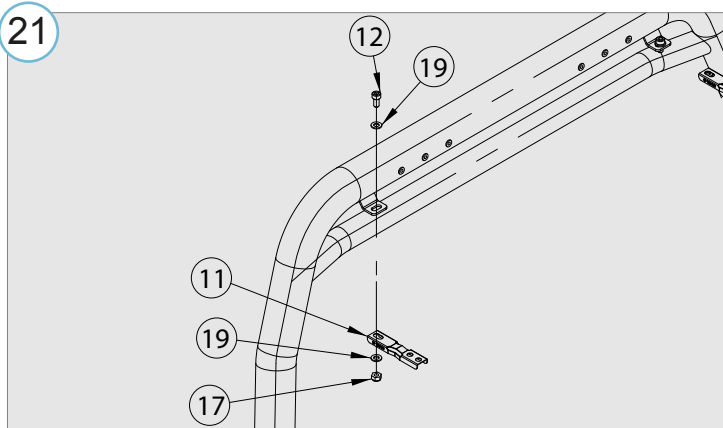
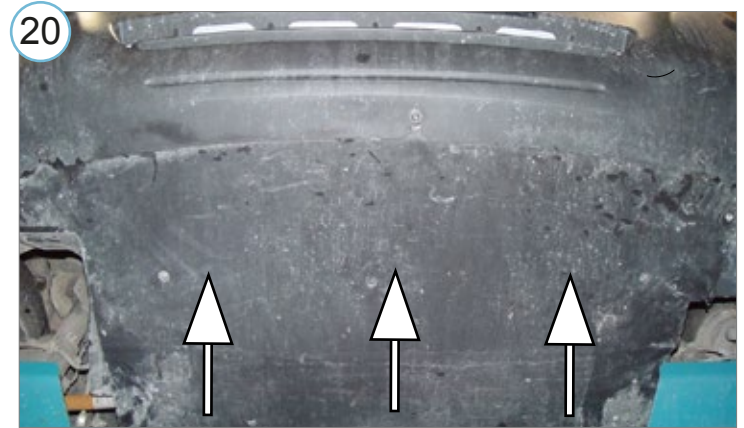
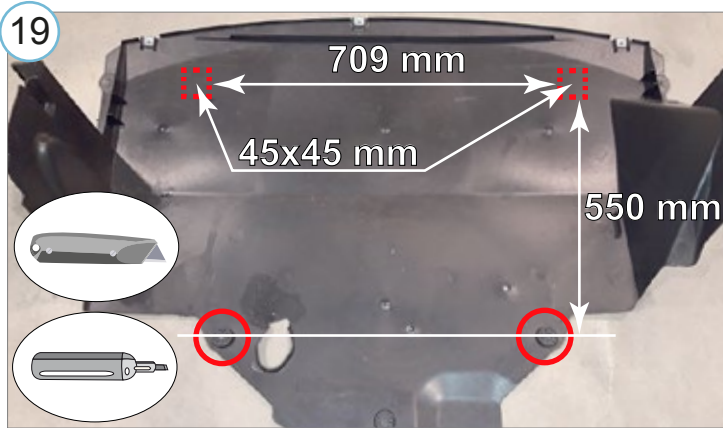
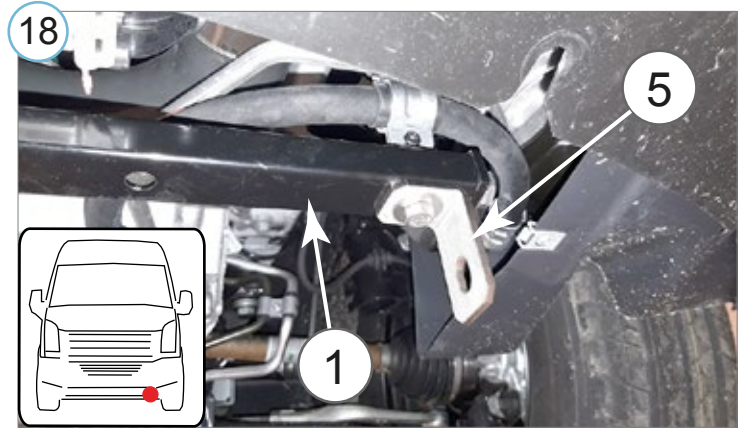
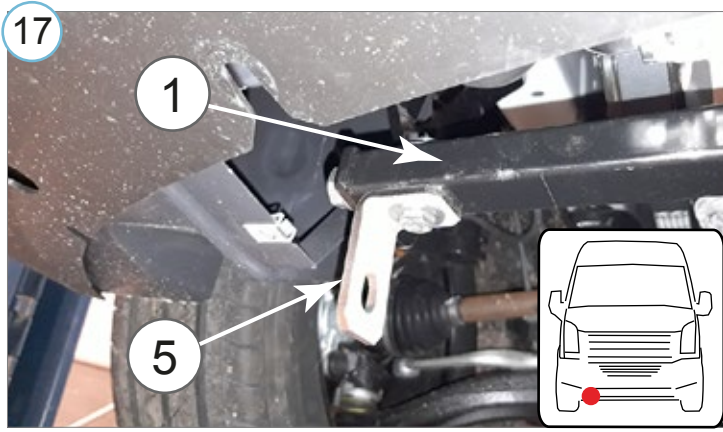

- Kui METEC toode ei vasta Teie ootustele või kui on tegemist toote ebapiisava kvaliteediga, siis pretensioonid esitada lehel www.metec.ee
- If the METEC product does not meet Your expectations or if it is a product of insufficient quality, then you can submit a claim at www.metec.ee
- Если METEC продукт не соответствует Вашим ожиданиям или это продукт недостаточного качества, то претензию предъявить можно на сайте www.metec.ee
- Wenn METEC Produkt nicht Ihren Erwartungen entspricht oder wenn es um Qualitätsmängel geht, dann bitte die Ansprüche auf Seite www.metec.ee einreichen

Lisa /extra / приложение / Extra

